

## KYOCERA SURFACE MOUNT CERAMIC PACKAGES FOR ELECTRONIC DEVICES

Inquiries about this list ?  
Please click here.

SAW Filter Package

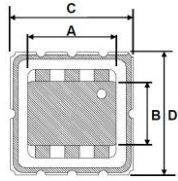

Monolithic Crystal Filter (MCF) Package

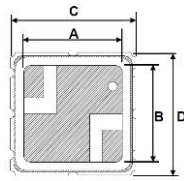

Oscillator (OSC) Package

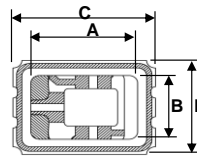

Crystal Package

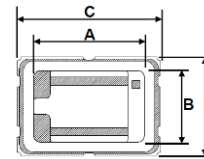

UNIT: mm

R0171H

No.	PACKAGE NAME	PACKAGE DRAWING NUMBER	SEAL METHOD	OVERALL DIMENSION C x D	CAVITY DIMENSION A x B	PACKAGE TOTAL THICKNESS	SOLDER PAD	KYOCERA MATERIAL CODE A440: BLACK A443: BLACK AO700: GRAY AO800: GRAY	MATCHING LID DRAWING NUMBER
1	1109 CSP PKG (*55.89X51.24 Panel)	KD-VB8643	---	(1.1)X(0.9)	---	0.16	5	A440	NOT AVAILABLE
2	1109 CSP PKG (*93.81 SQ. Panel)	KD-VB8641	---	(1.1)X(0.9)	---	0.16	5	A440	NOT AVAILABLE
3	1411CSP PKG (*55.89X51.24 Panel)	KD-VB7723-A	---	(1.4)X(1.1)	---	0.16	5	A440	NOT AVAILABLE
4	1411 CSP PKG (*93.81 SQ. Panel)	KD-VB6R92-A	---	(1.4)X(1.1)	---	0.16	5	A440	NOT AVAILABLE
5	2.0SQ PKG	KD-VB7D40	SOLDER	2.05X2.05	1.2X1.1	0.90	6	A440	NOT AVAILABLE
6	2.0SQ PKG	KD-VB7D42	EPOXY	2.05X2.05	1.2X1.1	0.90	6	A440	NOT AVAILABLE
7	2.5X2.0 PKG	KD-VB7B74	EPOXY	2.55X2.05	1.35X1.1	0.90	6	A440	NOT AVAILABLE
8	2.5X2.0 PKG	KD-VB7C66	SOLDER	2.55X2.05	1.35X1.1	0.90	6	A440	NOT AVAILABLE
9	3.0 SQ. PKG	KD-VB8707	SEAM	3.0X3.0	1.88X1.5	1.01	6	A443	KD-X99571-01
10	3.0 SQ. SAW PKG	KD-VB8450	SEAM	3.0X3.0	1.88X1.5	1.09	6	A443	KD-X99571-01
11	3.0 SQ. PKG	KD-VB7925-A-#	SOLDER	3.0X3.0	1.9X1.6	1.10	6	A440	NOT AVAILABLE
12	3.0 SQ. PKG	KD-VB7927	EPOXY	3.0X3.0	1.9X1.6	1.10	6	A440	KO-LID160782
13	3.8 SQ. PKG	KD-VB8709	SEAM	3.8X3.8	2.48X2.0	1.08	6	A440	KD-X99J15-01
14	3.8 SQ. SAW PKG	KD-VB8452	SEAM	3.8X3.8	2.8X2.0	1.09	6	A440	KD-X99J15-01
15	4.0 SQ. PKG	KD-VB7921	SOLDER	4.0X4.0	2.7X2.3	1.10	6	A440	NOT AVAILABLE
16	4.0 SQ. PKG	KD-VB7923	EPOXY	4.0X4.0	2.7X2.3	1.10	6	A440	NOT AVAILABLE
17	5.0 SQ. SAW PKG	KD-V99902-A-#	SEAM	5.0X5.0	3.6X2.6	1.25	8	A440	KD-X99587-01
18	5.0 SQ. PKG	KD-VB8711	SEAM	5.0X5.0	3.6X2.6	1.25	8	A440	KD-X99587-01
19	5.0 SQ. PKG	KD-VB7955	SOLDER	5.0X5.0	3.6X3.1	1.10	8	A440	NOT AVAILABLE
20	5.0 SQ. PKG	KD-VB7957	EPOXY	5.0X5.0	3.6X3.1	1.10	8	A440	KO-LID150102
21	5.2X4.8 SMD PKG	KD-V95B49-C-#	SEAM	5.2X4.8	3.2X2.4	1.35	8	A440	KD-X99572-01
22	7.0X5.0 PKG	KD-VB8759	SEAM	7.0X5.0	5.55X2.9	1.50	12	A443	KD-X99E83-01
23	7.0X5.0 PKG	KD-VB8A07	SOLDER	7.0X5.0	5.55X2.9	1.20	12	A443	NOT AVAILABLE
24	7.0X5.0 PKG	KD-VB8A27	EPOXY	7.0X5.0	5.55X2.9	1.20	12	A443	NOT AVAILABLE
25	9.1X7.1 SAW PKG	KD-V92457-A	SEAM	9.1X7.1	7.1X3.1	1.80 MAX	10	A440	KD-X99589-01
26	13.3X6.5 SAW PKG	KD-V92458-C-#	SEAM	13.3X6.5	10.1X4.5	1.80 MAX	12	A440	KD-X99592-01
27	13.3X6.5 SAW PKG	KD-V99377-A	SEAM	13.3X6.5	11.9X3.1	1.36	12	A443	KD-X99E84-01
28	15.9X6.5 SAW PKG	KD-V99376	SEAM	15.9X6.5	14.25X3.07	1.76	10	A443	KD-X99E91-01
29	19.0X6.5 SAW PKG	KD-VB4B84	SEAM	19.0X6.5	17.35X3.07	1.64	10	A440	KD-X99594-01
30	5.0 SQ. MEMS PKG (8LCC)	KD-VB3148-#	EPOXY	5.0X5.0	3.6X2.65	1.40	8	A440	KO-LID150102
31	5.0 SQ. MEMS PKG (8LCC)	KD-VA3E22-A-#	SOLDER	5.0X5.0	3.6X2.65	1.70	8	A440	NOT AVAILABLE
32	3.0 SQ. MCF PKG	KD-V99523	SEAM	3.0X3.0	2.2X2.2	0.80	8	A443	KD-XB8796
33	7.0X5.0 MCF PKG	KD-V96800	SEAM	7.0X5.0	5.4X3.6	1.20	6	A440	KD-XB8741
34	2.5X2.0 OSC PKG	KD-VA6K36-#	SEAM	2.5X2.0	1.9X1.4	0.82	4	A443	KD-XB8725
35	2.5X2.0 OSC PKG(6pads)	KD-VB6D45	SEAM	2.5X2.0	1.9X1.4	0.87	6	A443	KD-XB8725
36	3.2X2.5 OSC PKG	KD-VA5B23-A-#	SEAM	3.2X2.5	2.4X1.7	0.90	4	A443	KD-XB8727
37	3.2X2.5 OSC PKG	KD-VA6F60-A-#	SEAM	3.2X2.5	2.4X1.7	0.94	4	A443	KD-XB8727
38	3.2X2.5 OSC PKG(6pads)	KD-VB5A04	SEAM	3.2X2.5	2.4X1.7	0.80	6	A443	KD-XB8727
39	5.0X3.2 OSC PKG	KD-VA4247-#	SEAM	5.0X3.2	4.1X2.3	1.10	4	A443	KD-XB8733
40	6.0X3.5 OSC PKG	KD-V93128-C-#	SEAM	6.0X3.5	4.8X2.1	1.50	4	A440	KD-XB8737
41	7.0X5.0 OSC PKG	KD-VA1255-B-#	SEAM	7.0X5.0	5.4X3.6	1.50	6	A440	KD-XB8741
42	7.0X5.0 OSC PKG 1.2t	KD-VA7L69-#	SEAM	7.0X5.0	5.4X3.6	1.20	4	A443	KD-XB8741
43	7.0X5.0 OSC PKG 1.5t	KD-VA2J19-#	SEAM	7.0X5.0	5.4X3.6	1.50	4	A440	KD-XB8741
44	5.0X3.2 VCXO PKG	KD-VA4F51-A-#	SEAM	5.0X3.2	4.1X2.3	1.10	6	A443	KD-XB8733
45	7.0X5.0 VCXO PKG	KD-VA1806-#	SEAM	7.0X5.0	5.4X3.6	1.50	6	A440	KD-XB8741
46	7.0X5.0 TCXO PKG	KD-V98A45-A-#	-	7.0X5.0	2.8X2.6	0.70	10	A440	NOT AVAILABLE
47	1.65x1.25 XTAL PKG	KD-VB0M18	Au-Sn	1.65X1.25	1.33X0.93	0.25	4	AO700	KD-XB8969
48	2.05X1.65 XTAL PKG	KD-VA6K35-A	Au-Sn	2.05X1.65	1.65X1.25	0.42 MAX	4	AO700	KD-XB8965
49	2.05X1.65 XTAL PKG	KD-VA8547	SEAM	2.05X1.65	1.59X1.19	0.38	4	AO700	KD-XB8723
50	2.05X1.65 XTAL PKG (Au 0.1um min.)	KD-VB5176-A	SEAM	2.05X1.65	1.59X1.19	0.38	4	AO700	KD-XB8723
51	2.55X2.05 XTAL PKG	KD-VA9U01	SEAM	2.55X2.05	1.94X1.44	0.47	4	A443	KD-XB8725
52	3.2X2.5 XTAL PKG	KD-VA2L17-B-#	DIRECT SEAM®	3.2X2.5	2.3X1.6	0.50	4	A443	NOT AVAILABLE
53	3.2X2.5 XTAL PKG	KD-VA9237	SEAM	3.2X2.5	2.55X1.85	0.60	4	A443	KD-XB8729

No.	PACKAGE NAME	PACKAGE DRAWING NUMBER	SEAL METHOD	OVERALL DIMENSION C x D	CAVITY DIMENSION A x B	PACKAGE TOTAL THICKNESS	SOLDER PAD	KYOCERA MATERIAL CODE A440: BLACK A443: BLACK AO700: GRAY AO800: GRAY	MATCHING LID DRAWING NUMBER
54	4.0X2.5 XTAL PKG	KD-VA2K02-A	SEAM	4.0X2.5	3.2X1.7	0.55	4	A443	KD-XB8731
55	4.9X3.1 XTAL PKG	KD-V99F06	SEAM	4.9X3.1	4.0X2.2	0.65	4	A443	KD-XB8733
56	5.0X3.2 XTAL PKG	KD-V99951-#	DIRECT SEAM®	5.0X3.2	4.1X2.3	0.65	4	A443	KD-XA2A37
57	5.0X3.2 XTAL PKG	KD-V99087-C-#	SEAM	5.0X3.2	4.1X2.3	0.80	4	A443	KD-XB8735
58	6.0X3.5 XTAL PKG	KD-V99620-A	SEAM	6.0X3.5	4.8X2.3	0.90 MAX	4	A443	KD-XB8739
59	7.0X5.0 XTAL PKG	KD-V99624	SEAM	7.0X5.0	5.4X3.6	0.90	4	A443	KD-XB8741
60	7.0X5.0 XTAL PKG	KD-VA2H83-#	SEAM	7.0X5.0	5.4X3.6	0.90	4	A443	KD-XB8741
61	2.05X1.65 XTAL PKG	KD-VB1227	FRIT	2.05X1.65	1.65X1.25	0.355	4	AO700	KC-LID110650-A
62	2.5X2.0 XTAL PKG	KD-VA7L96	FRIT	2.5X2.0	2.1X1.6	0.45	4	A440	A-000021-C1
63	3.2X2.5 XTAL PKG	KD-V99358-A-#	FRIT	3.2X2.5	2.3X1.6	0.50	4	A443	A-000020-C1
64	3.2X2.5 XTAL PKG (Au 0.1um min.)	KD-VB5B86-A	SEAM	3.2X2.5	2.55X1.85	0.60	4	A443	KD-XB8729
65	4.0X2.5 XTAL PKG	KD-V99362-A-#	FRIT	4.0X2.5	3.1X1.6	0.60	4	A443	A-009201-01
66	5.0X3.2 XTAL PKG	KD-V97845-B-#	FRIT	5.0X3.2	3.7X2.0	0.60	2	A440	A-000003-A1
67	5.0X3.2 XTAL PKG	KD-V99E57-A-#	FRIT	5.0X3.2	4.0X2.2	0.65	4	A440	A-000011-A1
68	5.0X3.2 XTAL PKG	KD-VA1998-A	FRIT	5.0X3.2	4.0X2.2	0.60	2	A440	A-000011-A1
69	6.0X3.5 XTAL PKG	KD-V98642-B-#	FRIT	6.0X3.5	4.8X2.3	0.60	2	A440	A-000005-A1
70	7.0X5.0 XTAL PKG	KD-V99352	FRIT	7.0X5.0	5.4X3.6	0.60	2	A440	A-000007-A1
71	7.0X5.0 XTAL PKG	KD-VA0637	FRIT	7.0X5.0	5.4X3.6	0.60	4	A440	A-000007-A1
72	8.0X4.5 XTAL PKG	KD-VA0B08-#	FRIT	8.0X4.5	6.0X3.0	0.80	2	A440	A-009024-K4
73	3.2X1.5 TF XTAL PKG	KD-VA7071	Au-Sn	3.2X1.5	2.5X0.8	0.50	2	A443	KD-XB8967
74	4.1X1.5 TF XTAL PKG	KD-VA3E35	Au-Sn	4.1X1.5	3.4X0.8	0.70	2	A440	KD-XB8963
75	1.22X1.02 XTAL PKG	KD-VB7A16	SEAM	1.22X1.02	0.95X0.75	0.30MAX	4	AO800	KD-XB7H08
76	1.22X1.02 XTAL PKG	KD-VB5F28	Au-Sn	1.22X1.02	0.98X0.78	0.20	4	AO800	KD-XB8961
77	1.65X1.25 XTAL PKG	KD-VB7S45-B	SEAM	1.65X1.25	1.33X0.93	0.27 MAX	4	AO700	KD-XB8743
78	6.22X4.32 DIODE PKG (6LCC)	KD-V94364-A-#	Au-Sn	6.22X4.32	4.45X2.54	1.40	6	A440	NOT AVAILABLE
79	3.05X2.54 DIODE PKG (3LCC)	KD-VA0219-#	Au-Sn	3.05X2.54	1.78X1.27	1.02	3	A440	NOT AVAILABLE

\* DIRECT SEAM is a registered trademark of KYOCERA Corporation in Japan

\*\* In the case of package drawing number with -#, please select piece part or array sheet for shipment from Kyocera.

\*\*\* Contents in this list are subject to change without notice. It is recommended to confirm the latest information at the time of usage.  
We may not be able to accept requests based on old list.