

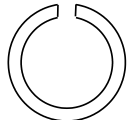

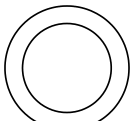
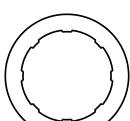

Standard Sleeve Product List

φ2.5mm Sleeve	<p><u>1. SPLIT TYPE (2p)</u></p> <p><u>2. PRECISION TYPE (3P)</u></p> <p><u>3. 8 LAND PRECISION TYPE (4P)</u> (Air Pressure / Dust Release Structure)</p>	  
φ1.25mm Sleeve	<p><u>4. SPLIT TYPE (5P)</u></p> <p><u>5. PRECISION TYPE (6P)</u></p> <p><u>6. 6 LAND PRECISION TYPE (7P)</u> (Air Pressure / Dust Release Structure)</p>	  

1. $\phi 2.5$ SPLIT SLEEVE

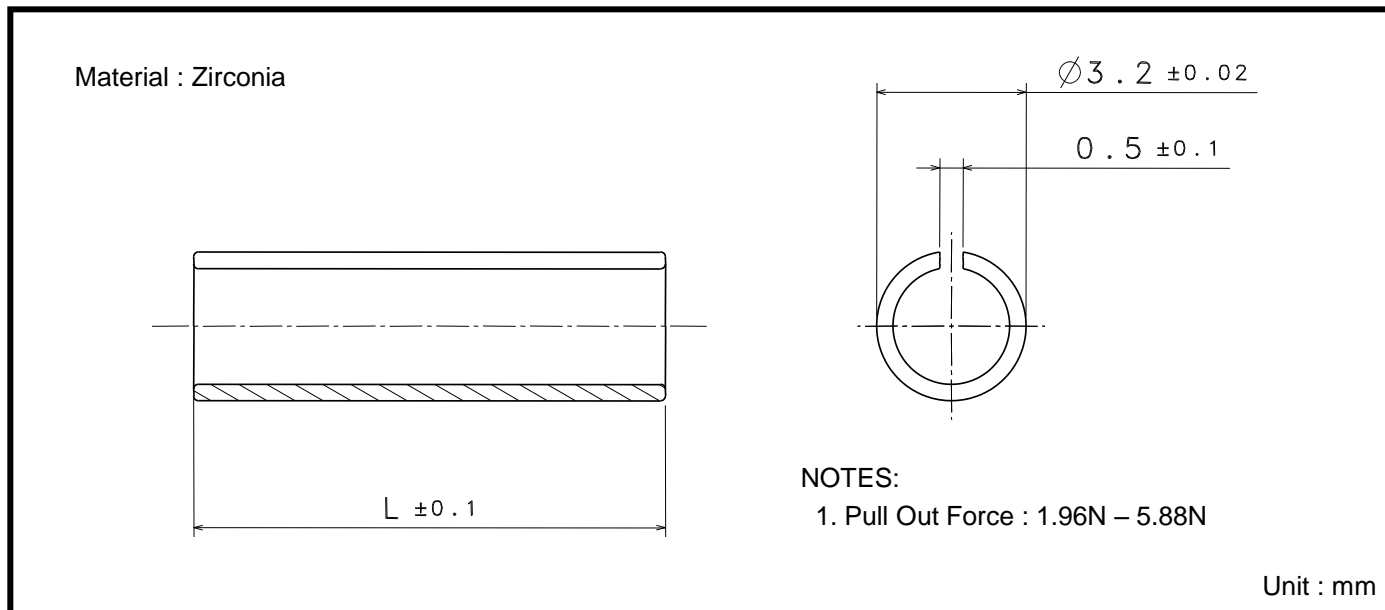

■ Inquiry Code

K C S S 250 -

└─ **Length (L)**

1: 11.4mm for SC / FC connector

2: 10.1mm for ST Connector

■ For other length, please contact a KYOCERA sales engineer.

ST is a registered trademark of Furukawa Electric North America, Inc. in the United States of America.

2. $\phi 2.5$ PRECISION SLEEVE

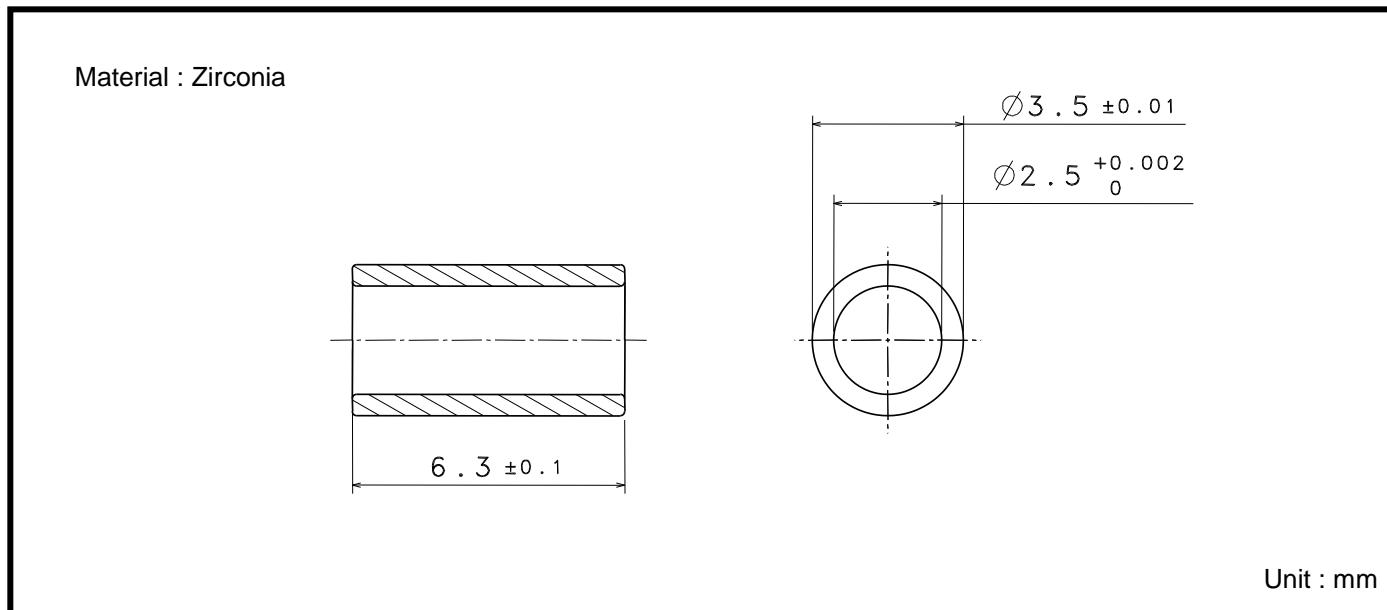

■ Inquiry Code

K C P S 250 - 1

■ For other length and diameters, please contact a KYOCERA sales engineer.

3. $\phi 2.5$ PRECISION SLEEVE (8 LAND)

Air Pressure / Dust Release Structure

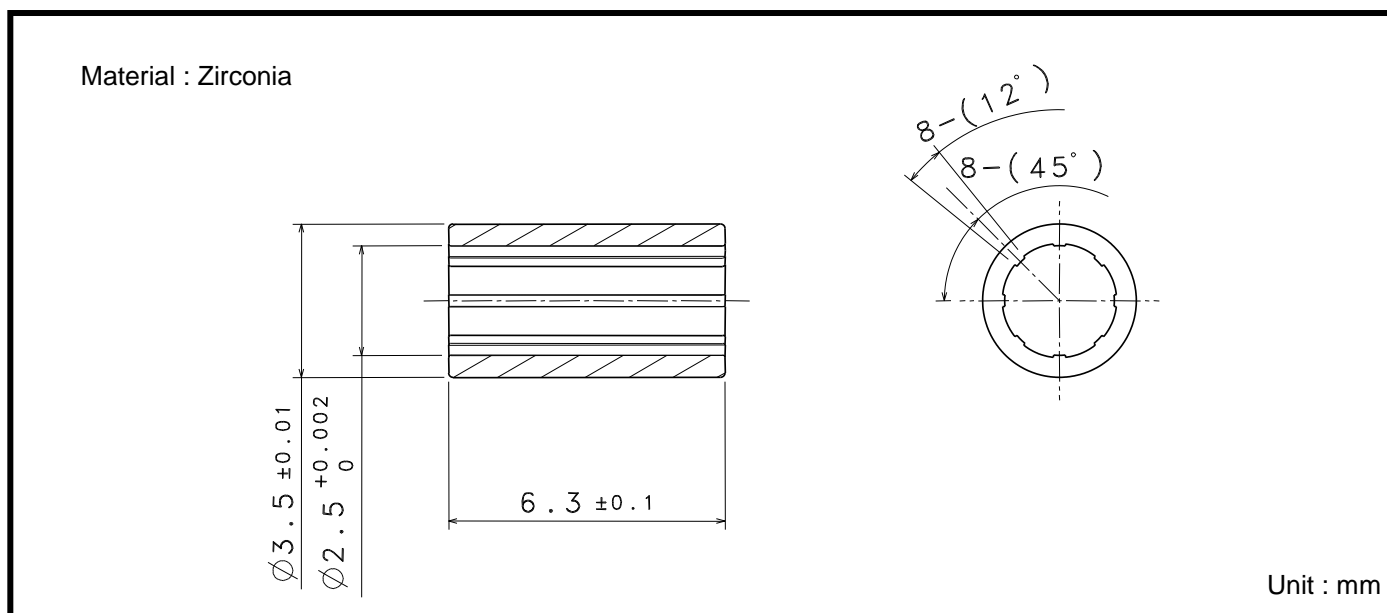

■ Inquiry Code

K C P S 250 - 2

■ For other length and diameters, please contact a KYOCERA sales engineer.

4. $\phi 1.25$ SPLIT SLEEVE

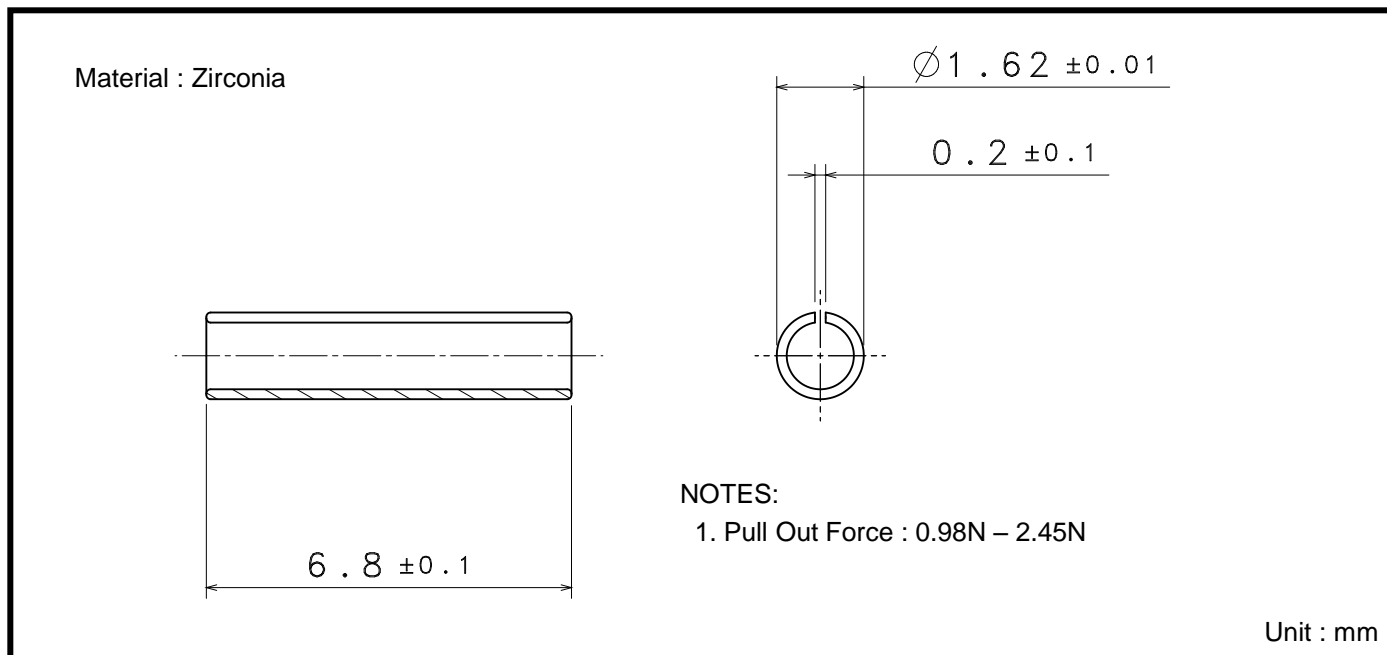

Inquiry Code

K C S S 125

 For other length, please contact a KYOCERA sales engineer.

5. $\phi 1.25$ PRECISION SLEEVE

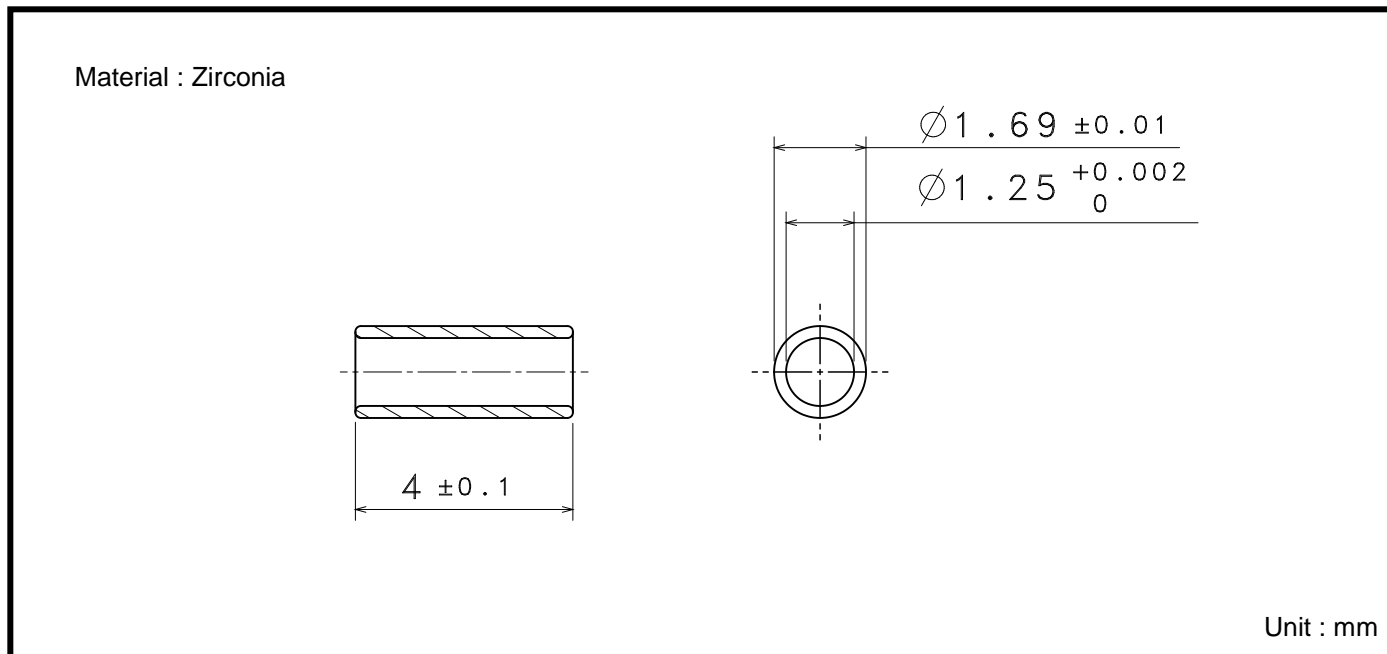

■ Inquiry Code

K C P S 125 - 1

■ For other length and diameters, please contact a KYOCERA sales engineer.

6. $\phi 1.25$ PRECISION SLEEVE (6 LAND)

Air Pressure / Dust Release Structure

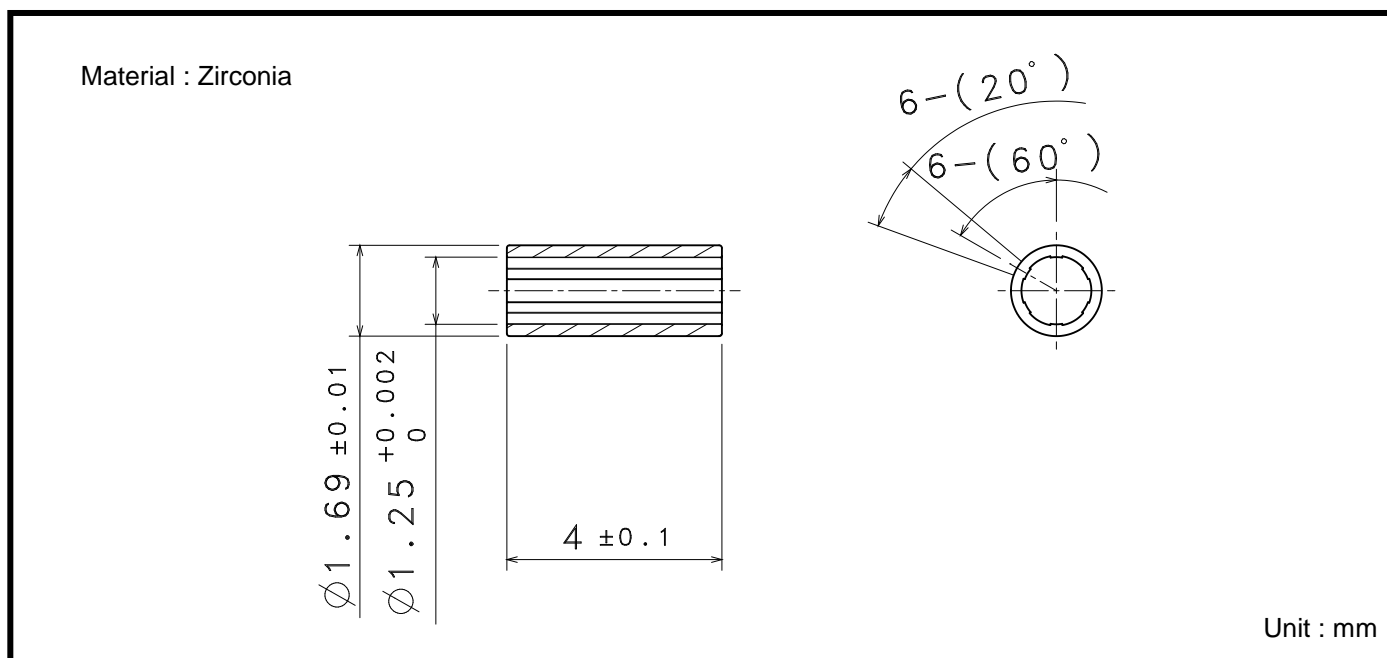

■ Inquiry Code

K C P S 125 - 2

■ For other length and diameters, please contact a KYOCERA sales engineer.